

PIN OUT: 1 2 3 6 4 5 7 8

 1 2 3 6 4 5 7 8
 白橙/橙 白绿/绿 蓝/白蓝 白棕/棕

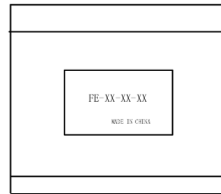

PART NO.	LENGTH
	305MM (1FT) ± 30MM
	610MM (2FT) ± 30MM
	915MM (3FT) ± 40MM
	1525MM (5FT) ± 50MM
	2135MM (7FT) ± 50MM
	3050MM (10FT) ± 50MM
	4268MM (14FT) ± 800MM
	6100MM (20FT) ± 100MM
	76220M (25FT) ± 100MM

My Cable Mart, LLC

Title:
CAT. 5e UTP Cable

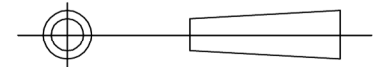

Customer: MY CABLE MARKET LLC

Page: 1/1

Drawn BY: CLR

Customer P/N:

REV: A1

Check BY: DYH

Date: 2016. 09. 09

Drawing NO.: RJ45

Unit: mm

Appd BY:

9		
8		
7		
6		
5		
4		
3		45Pa PVC
2		RJ45 8P8C CONN.
1		Cat. 5e UTP Cable 24AWG (7/0.2BC)*4P OD: 5.5MM BLUE
NO.	Material	Description